

ポートアイランド確定図 S=1:1,000 港島中町7丁目

平成3年6月作成

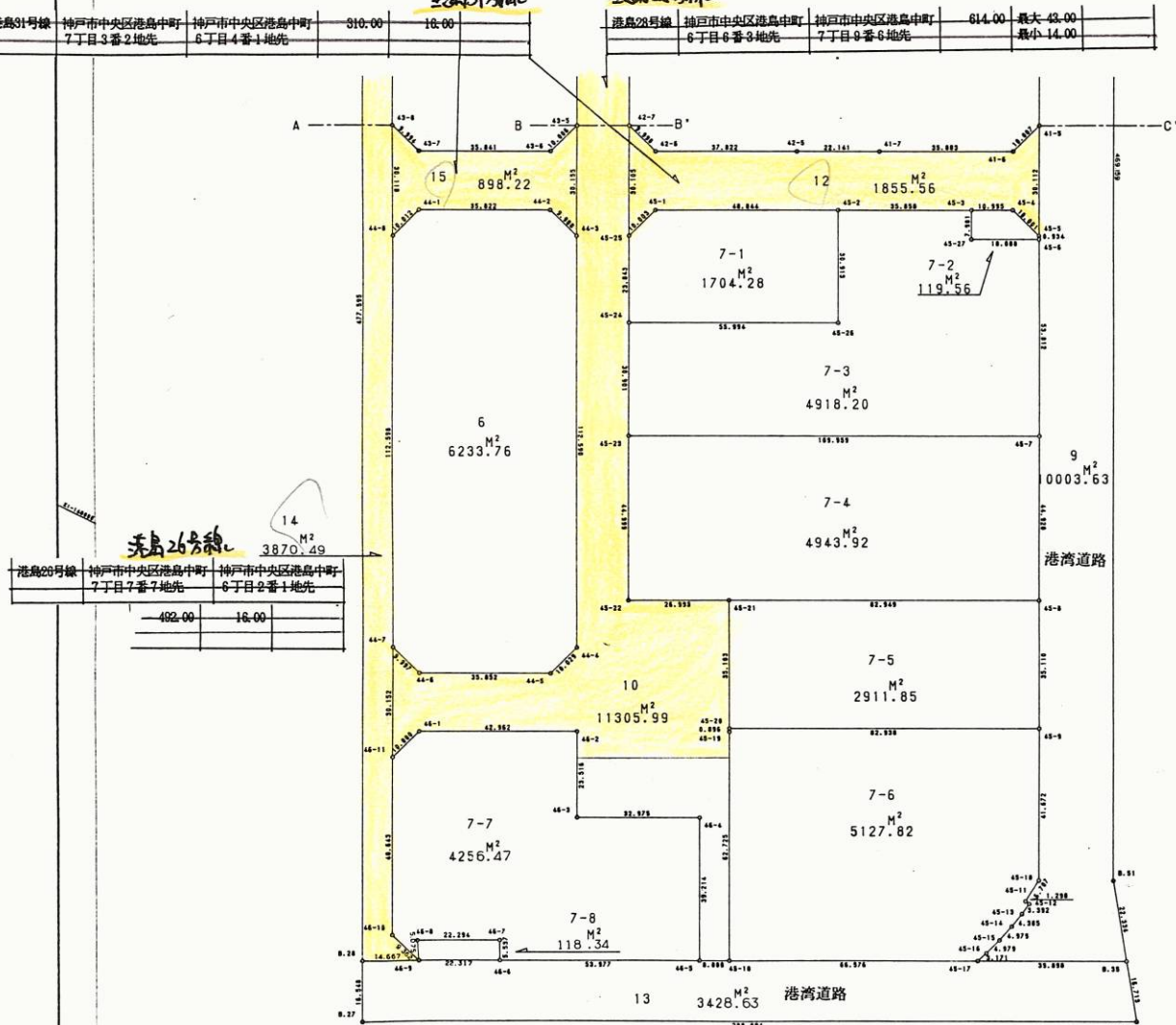
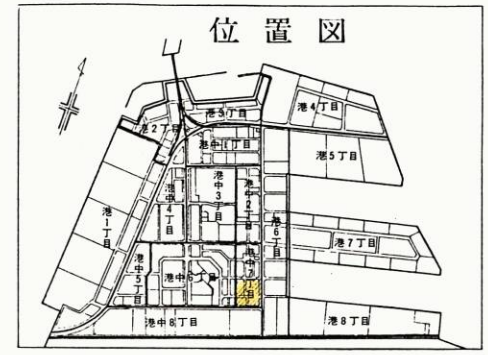

地番 6 地目

点名	X	Y	辺長
44-1	-147884.196	81182.269	10.012
44-8	-147893.714	81179.163	112.598
44-7	-147994.194	81229.977	9.997
44-6	-147997.336	81239.467	35.852
44-5	-147981.173	81271.469	10.029
44-4	-147971.644	81274.596	112.590
44-3	-147871.198	81223.733	9.988
44-2	-147868.060	81214.251	35.822
面積	6233.7618675		
地積	6233.76		

地番 7-1 地目

点名	X	Y	辺長
45-1	-147855.329	81239.357	10.003
45-25	-147864.818	81236.193	23.843
45-24	-147886.102	81246.939	55.994
45-26	-147860.847	81296.914	30.913
45-2	-147833.274	81282.938	48.844
面積	1704.2875240		
地積	1704.28		

地番 7-2 地目

点名	X	Y	辺長
45-3	-147817.090	81314.936	7.981
45-27	-147824.218	81318.526	18.088
45-6	-147816.049	81334.664	0.934
45-5	-147815.218	81334.237	10.001
45-4	-147812.102	81324.734	10.995
面積	119.5641905		
地積	119.56		

地番 7-3 地目

点名	X	Y	辺長
45-2	-147833.274	81282.938	30.913
45-26	-147860.847	81296.914	55.994
45-24	-147886.102	81246.939	30.901
45-23	-147913.675	81260.889	109.959
45-7	-147864.040	81359.008	53.812
45-6	-147816.049	81334.664	18.088
45-27	-147824.218	81318.526	7.981
45-3	-147817.090	81314.936	35.858
面積	4918.2038010		
地積	4918.20		

地番 7-4 地目

点名	X	Y	辺長
45-23	-147913.675	81260.889	44.999
45-22	-147953.817	81281.224	26.993
45-21	-147941.620	81305.304	82.949
45-8	-147904.126	81379.296	44.928
45-7	-147864.040	81359.008	109.959
面積	4943.9204595		
地積	4943.92		

地番 7-5 地目

点名	X	Y	辺長
45-21	-147941.620	81305.304	35.103
45-20	-147972.947	81321.142	82.938
45-9	-147935.464	81395.127	35.110
45-8	-147904.126	81379.296	82.949
面積	2911.8563295		
地積	2911.85		

地番 7-6 地目

点名	X	Y	辺長
45-20	-147972.947	81321.142	0.896
45-19	-147873.747	81321.546	62.725
45-18	-148029.727	81349.841	66.576
45-17	-147999.714	81409.268	3.171
45-16	-147996.739	81410.365	4.979
45-15	-147992.001	81411.894	4.979
45-14	-147987.176	81413.122	4.385
45-13	-147982.880	81414.002	3.392
45-12	-147979.529	81414.527	1.290
45-11	-147979.345	81413.250	6.707
45-10	-147972.669	81413.898	41.672
45-9	-147935.464	81395.127	82.938
面積	5127.8289355		
地積	5127.82		

地番 7-7 地目

点名	X	Y	辺長
46-1	-148011.596	81246.666	10.000
46-11	-148021.106	81243.574	48.643
46-10	-148064.521	81265.511	9.362
46-9	-148067.379	81274.426	5.075
46-8	-148062.840	81272.155	22.294
46-7	-148052.755	81292.037	5.537
46-6	-148057.697	81294.534	53.977
46-5	-148033.342	81342.704	39.214
46-4	-147998.334	81325.036	32.975
46-3	-148013.219	81295.612	23.516
46-2	-147992.227	81285.014	42.962
面積	4256.4724890		
地積	4256.47		

地番 7-8 地目

点名	X	Y	辺長
46-8	-148062.840	81272.155	5.075
46-9	-148067.379	81274.426	22.317
46-6	-148057.697	81294.534	5.537
46-7	-148052.755	81292.037	22.294
面積	118.3485615		
地積	118.34		

地番 9 地目

点名	X	Y	辺長
39-36	-147554.061	81202.103	26.020
39-3	-147577.276	81213.855	29.213
39-4	-147603.357	81227.014	28.456
39-5	-147628.749	81239.859	17.087
39-10	-147643.988	81247.587	4.055
40-2	-147647.599	81249.431	24.939
40-3	-147669.860	81260.674	22.130
41-3	-147689.561	81270.753	60.122
41-4	-147743.260	81297.791	50.549
41-5	-147788.335	81320.670	30.112
45-5	-147815.218	81334.237	0.934
45-6	-147816.049	81334.664	53.812
45-7	-147864.040	81359.008	44.928
45-8	-147904.126	81379.296	35.110
45-9	-147935.464	81395.127	41.672
45-10	-147972.669	81413.898	6.707
45-11	-147979.345	81413.250	1.290
45-12	-147979.529	81414.527	3.392
45-13	-147982.880	81414.002	4.385
45-14	-147987.176	81413.122	4.979
45-15	-147992.001	81411.894	4.979
45-16	-147996.739	81410.365	3.171
45-17	-147999.714	81409.268	39.898
39-35	-147981.728	81444.881	22.334
39-51	-147963.664	81431.747	469.159
39-37	-147945.034	81219.948	19.998
面積	10003.6395630		
地積	10003.63		

地番 10 地目

点名	X	Y	辺長
38-2	-147608.475	81124.461	76.243
38-3	-147676.503	81158.888	9.998
38-4	-147686.006	81155.780	22.930
38-5	-147696.308	81135.294	32.993
38-6	-147725.733	81150.218	28.142
43-3	-147750.864	81162.884	77.765
43-4	-147820.252	81197.993	26.924
43-5	-147844.274	81210.153	30.155
44-3	-147871.198	81223.733	112.590
44-4	-147971.644	81274.596	10.029
44-5	-147981.173	81271.469	35.852
44-6	-147997.336	81239.467	9.997
44-7	-147994.194	81229.977	30.152
46-11	-148021.106	81243.574	10.000
46-1	-148011.596	81246.666	42.962
46-2	-147992.227	81285.014	23.516
46-3	-148013.219	81295.612	32.975
46-4	-147998.334	81325.036	39.214
46-5	-148033.342	81342.704	8.000
45-18	-148029.727	81349.841	62.725
45-19	-147973.747	81321.546	0.896
45-20	-147972.947	81321.142	35.103
45-21	-147941.620	81305.304	26.993
45-22	-147953.817	81281.224	44.999
45-23	-147913.675	81260.889	30.901
45-24	-147864.818	81236.193	23.843
42-7	-147837.943	81222.627	26.933
42-8	-147813.902	81210.486	98.816
42-9	-147725.736	81165.861	10.014
42-1	-147716.218	81168.972	44.864
42-2	-147695.968	81209.006	7.053
42-10	-147702.261	81212.191	3.954
40-5	-147700.485	81215.724	31.986
40-1	-147671.905	81201.362	53.865
40-2	-147647.599	81249.431	4.055
39-10	-147643.988	81247.587	4.481
39-11	-147646.080	81243.624	17.158
39-12	-147630.773	81235.873	3.988
39-6	-147632.589	81232.923	13.160
39-7	-147644.317	81238.293	71.397
39-8	-147676.518	81174.570	41.588
39-9	-147639.415	81155.784	41.760
39-1	-147602.156	81136.924	13.973
面積	11305.9920305		
地積	11305.99		

地番 13 地目

点名	X	Y	辺長
39-28	-148074.398	81261.548	16.548
39-27	-148089.165	81269.016	208.094
39-34	-147995.245	81454.710	16.713
39-35	-147981.728	81444.881	39.898
45-17	-147972.714	81409.268	66.576
45-18	-148029.727	81349.841	8.000
46-5	-148033.342	81342.704	53.977
46-6	-148057.697	81294.534	22.317
46-9	-148067.379	81274.426	14.667
面積	3428.6313285		
地積	3428.63		

地番 14 地目

点名	X	Y	辺長
39-29	-147648.213	81045.994	477.595
39-28	-148074.398	81261.548	14.667
46-9	-148067.379	81274.426	9.362
46-10	-148064.521	81265.511	48.643
46-11	-148021.106	81243.574	30.152
44-7	-147994.194	81229.977	112.598
44-8	-147993.714	81179.163	30.118
43-8	-147866.843	81165.559	26.936
43-9	-147842.810	81153.396	77.760
43-10	-147773.429	81118.283	21.061
39-8	-147754.653	81108.743	40.048
39-9	-147718.898	81090.703	76.133
39-10	-147650.959	81056.345	9.917
39-1	-147641.472	81059.234	14.857
面積	3870.4921240		
地積	3870.49		

地番 15 地目

点名	X	Y	辺長
43-8	-147866.843	81165.559	30.118
44-8	-147893.714	81179.163	10.012
44-1	-147884.196	81182.269	35.822
44-2	-147868.060	81214.251	9.988
44-3	-147844.274	81223.733	30.155
43-6	-147853.782	81207.037	35.841
43-7	-147869.960	81175.055	9.994
面積	898.2257240		
地積	898.22		

玉野総合コンサルタント調製

神戸市開発局
港島整備局新都市整備本部経営管理課

神戸市開発局